



# RIVERTOWNE PLACE

South Carolina's First  
LEED®-Registered Shopping Center



**FOX** CAPITAL PARTNERS

Bringing *new energy* to the center.



# RIVERTOWNE PLACE

## Mt. Pleasant, South Carolina

- Located at SC Hwy 41 at the entrance to Rivertowne Plantation, Park West and Dunes West
- South Carolina's first LEED®-registered shopping center
- A joint venture between Fox Capital Partners and Harris Teeter



FOX CAPITAL PARTNERS



# LOCATION



# SITE PLAN

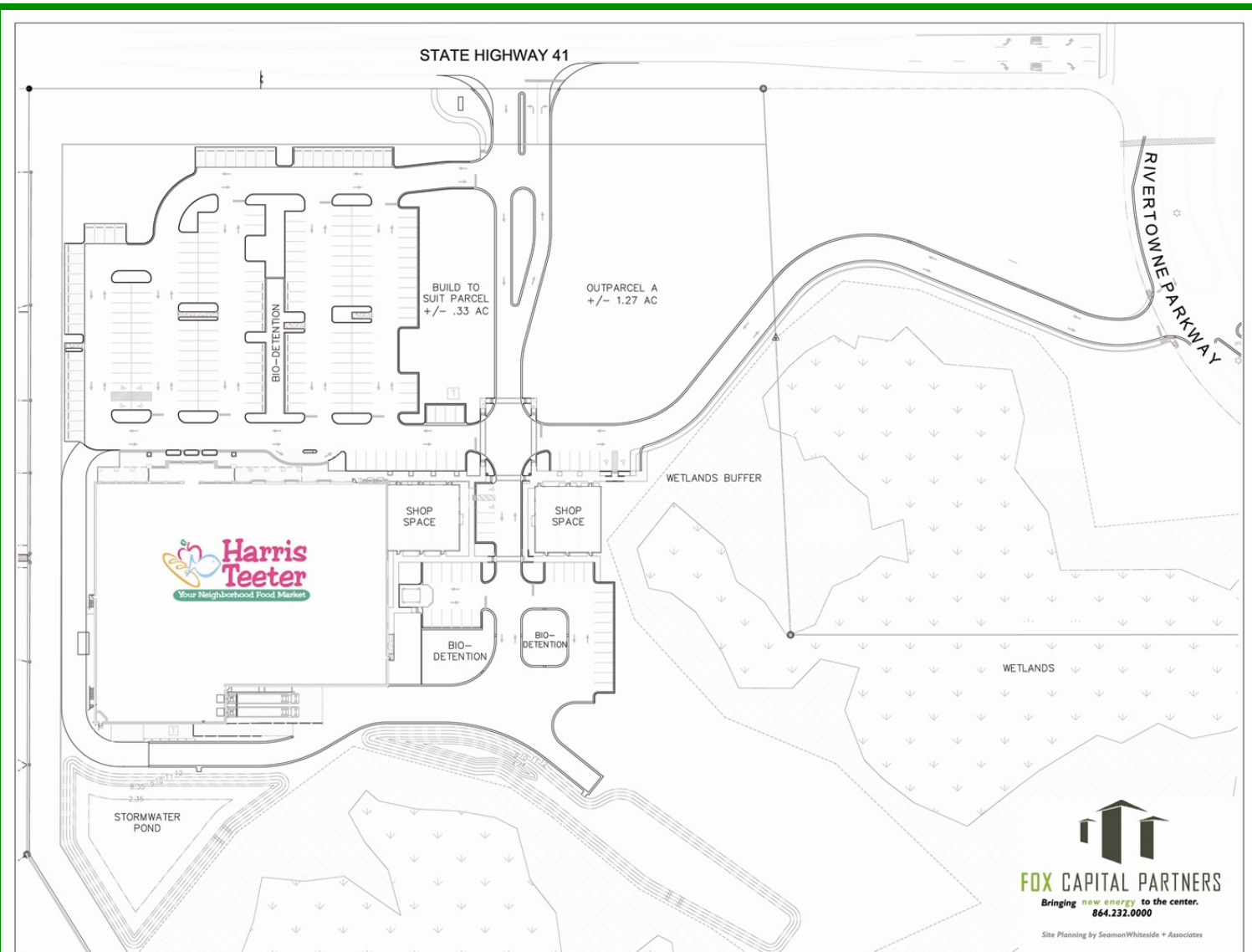

## RIVERTOWNE PLACE MT. PLEASANT, SOUTH CAROLINA

SITE PLAN SCALE: 1"= 40'



# RIVERTOWNE PLACE VITAL STATS

Located at the intersection of Affluence & Education

<b>Population</b>	<b>3-mile radius</b>	<b>5-mile radius</b>
•2008 Estimated population	17,270	39,321
•2013 Projected population	22,262	46,490
•2000—2008 Growth %	116.83	50.47
•2008—2013 Growth %	28.91	18.23
•2008 Est median age	35.95	37.09
<b>Housing</b>		
•2008 Est avg HH size	2.76	2.61
•2008 Est avg housing value	\$436,483	\$377,413



**FOX** CAPITAL PARTNERS





## VITAL STATS (cont.)

Income	3-mile radius	5-mile radius
•2008 Est avg HH income	\$119,756	\$101,195
Education		
•Associate Degree	806 (7.8%)	1,804 (7.3%)
•Bachelor's Degree	3,777 (36.6%)	8,078 (32.6%)
•Master's Degree	1,052 (10.2%)	2,600 (10.5%)
•Professional Degree	657 (6.4%)	1,217 (4.9%)
•Doctoral Degree	224 (2.2%)	553 (2.2%)
Traffic Count (March 2009)		
•Hwy 41-in front of site	17,645 VPD	
•Dunes West Boulevard	9,226 VPD	





## TAP INTO THE NEW ENERGY

- Grocery-anchored shopping center featuring the new Harris Teeter prototype
- Sustainable, environmentally sensitive design
- The responsiveness of local management
- Shop space for restaurants and retail



FOX CAPITAL PARTNERS



## FOR MORE INFORMATION

Contact us at 864.232.0000 or  
[info@foxcappartners.com](mailto:info@foxcappartners.com)



---

**FOX** CAPITAL PARTNERS